



Project Report on
SKILL DEVELOPMENT CENTRE
@ Tal. Velhe, Dist. Pune, Maharashtra 412303, INDIA
by



TORANA RAJGAD PARISAR SAMAJONNATI NYAS

Reg. No. E/1369/Pune/ 30.07.1990

At post Velhe, Dist. Pune 412212. Maharashtra (India)

Telephone :02130-221450 E-mail : toranarajgadnyas@gmail.com website : www.toranarajgadnyas.org

Velhe - Bhor Talukas

No development, successive poverty!

Life Challenges

- Extreme weather (extreme rains, yet extreme water scarcity)
- Lack of water storage
- Rice is the only crop cultivated
- Lack of Basic Facilities like water, Electricity, Roads etc.
- Lack of transportation and communication systems
- Losing pride in farming
- **No development**
- **Successive high poverty index**
- **No Employment**
- **Young men migrate to cities to earn their livelihood**

Intrinsic Plus Points

- Nature abundance
- Highest rainfall
- Neighbouring to urban area
- Pollution free

Pune District

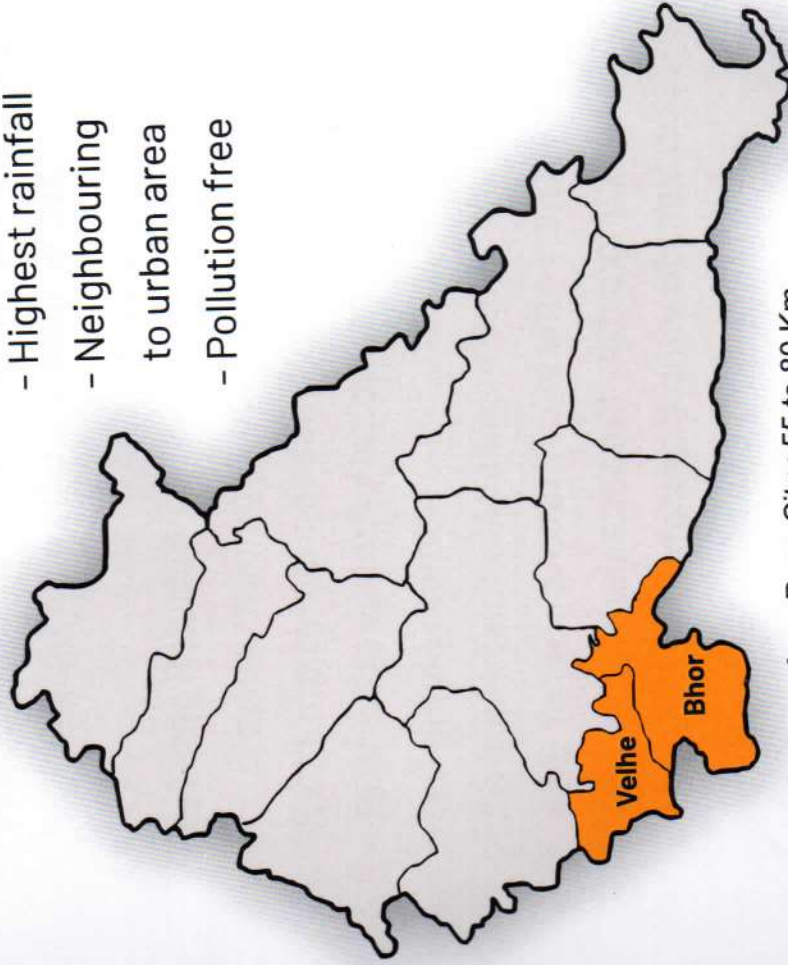

Distance from Pune City : 55 to 80 Km.
Population : Velhe : 70,000; Bhor : 2,15,000
Total Population : Approx. 2,85,000

Steps to be taken

Little help and imparting ethical values will make them self reliant !

Goal to be achieved

- Villagers should be able to stay at their villages and earn their livelihood and restrict migration to urban areas.

Probable Solution

- To provide training to develop employment based skills which will generate Self Employment at same place
- To provide various platforms to practice their thoughts related to self employment
- To impart ethical values to make them able to face any difficulty with confidence and carry their success with dignity
- To enhance pride and dignity of their culture, lifestyle, farming and their own village



Self Employment Foreseeable Areas

Contemplating Geographical, Agricultural and other resources which can fetch self employment

Agriculture

- Soil Testing
- Water Conservation
- Organic Farming
- Repeat Crops
- Modern Techniques
- Medicinal Plantation
- Cow Products

Soft Skills

- Computer Training
- Personality Development
- Professionalism
- Digital Marketing

Women Employment

- Food Products
- Processed Food
- Stitching
- Fashion & Beauty
- Gift Articles
- Quilt Sewing

Supportive Skills

- Social Welfare
- Rural Development
- FPO, FPC Formation and Administration
- MPSC & UPSC Preparation

Youth Employment

- Agro Tourism
- Trekking
- Poultry
- Nursing & Paramedical
- Bamboo Craft & Art
- Yoga & Massage
- Rice Dehusking
- Dairy Products
- Naturopathy
- Skill Based
- Electrician
- Plumber
- Mobile Repairing

Role of an NGO



TORANA RAJGAD PARISAR SAMAJONNATI NYAS

॥ Vidya Vikasen Shobhate ॥

॥ विद्या विकासेन शोभते ॥



EDUCATION



HEALTH



RURAL DEVELOPMENT

Role of an NGO



TORANA RAJGAD PARISAR SAMAJONNATI NYAS

॥ Vidya Vikasen Shobhate ॥

॥ विद्या विकासेन शोभते ॥

Since 1986, following the Sanskrit Axiom 'Vidya Vakaasen Shobhate', and inspired by Vishwa Hindu Parishad and Rastriya Swayamsevak Sangha (RSS), the Nyas is striving to bring about development of Velhe and Bhor as well as adjoining villages in remote areas through education.

Based on Education - Rural Development - Rural Health - Rural Security, Nyas is getting together villagers in the area with the aim of inculcating and promoting patriotism.

The Nyas has been successful in inculcating moral values, discipline and social responsibility in the next generation by promoting education and maintain the environment of peace and understanding.

Role of an NGO



TORANA RAJGAD PARISAR SAMAJONNATI NYAS
assures it's rigorous and meticulous efforts ...

- To involve in day to day life of villagers
- To undertake continual process of minute study of geographical mentality, Natural Resources and Individual Capabilities
- To strive hard for not only to train the people, but to support them till they achieve their goal
- To get associated with and to arrange training by reputed Training Organisations and Experts from the Society
- To bridge the gap between needy people and Training Organisations by coordination and continual efforts
- To get associated with prospective commercial companies and organisations and assure potential market for the new entrepreneurs
- To provide well equipped infrastructure to run the activities under skill development centre
- To generate adequate funds through CSR to ensure uninterrupted Training activity

Associations for Skill Development

TORANA RAJGAD PARISAR SAMAJONNATI NYAS

has already been associated with following eminent institutions.

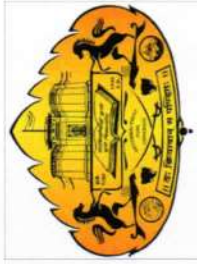

Savitribai Phule
Pune University



Deccan Education Society's
Brihan Maharashtra College of Commerce (BMCC)



Skill Development Centre & Multi Utility Building @ Velhe



Individual Floor Area : 8543 sq. ft.
No. of Floors : Ground + 3
Total Built up Area : 34172 sq. ft.

Site Layout Plan

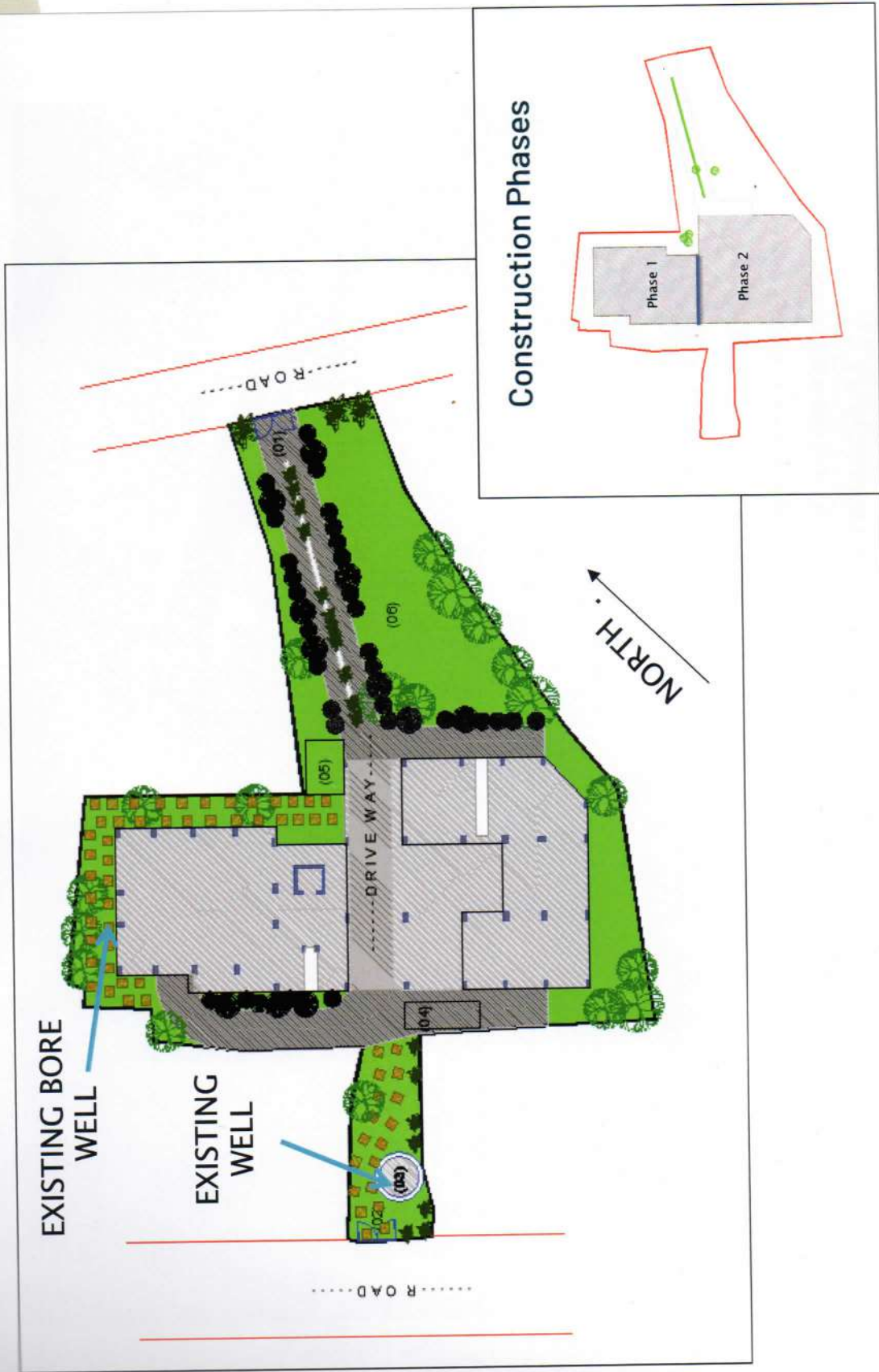

Ground Floor Plan



- 1 - Training Hall
- 2 & 8 - Wash Rooms
- 3 - Lift Duct
- 4 - E- Seva Centre
- 5 - TRPSN Reception
- 6 - Kitchen
- 7 - Dining

Phase 1 : 307 sq.m. (3303.32 sq.ft.)

Estimated Amount : Rs. 1.25 Crore

(Amount includes Pile Foundation & Plinth

Phase 2 : 487 sq.m. (5240.12 sq.ft.)

Estimated Amount : Rs. 1.46 Crore

(Amount includes Pile Foundation & Plinth

Total Built-up Area : 794 sq.m. (8543.44 sq.ft.)

First Floor Plan

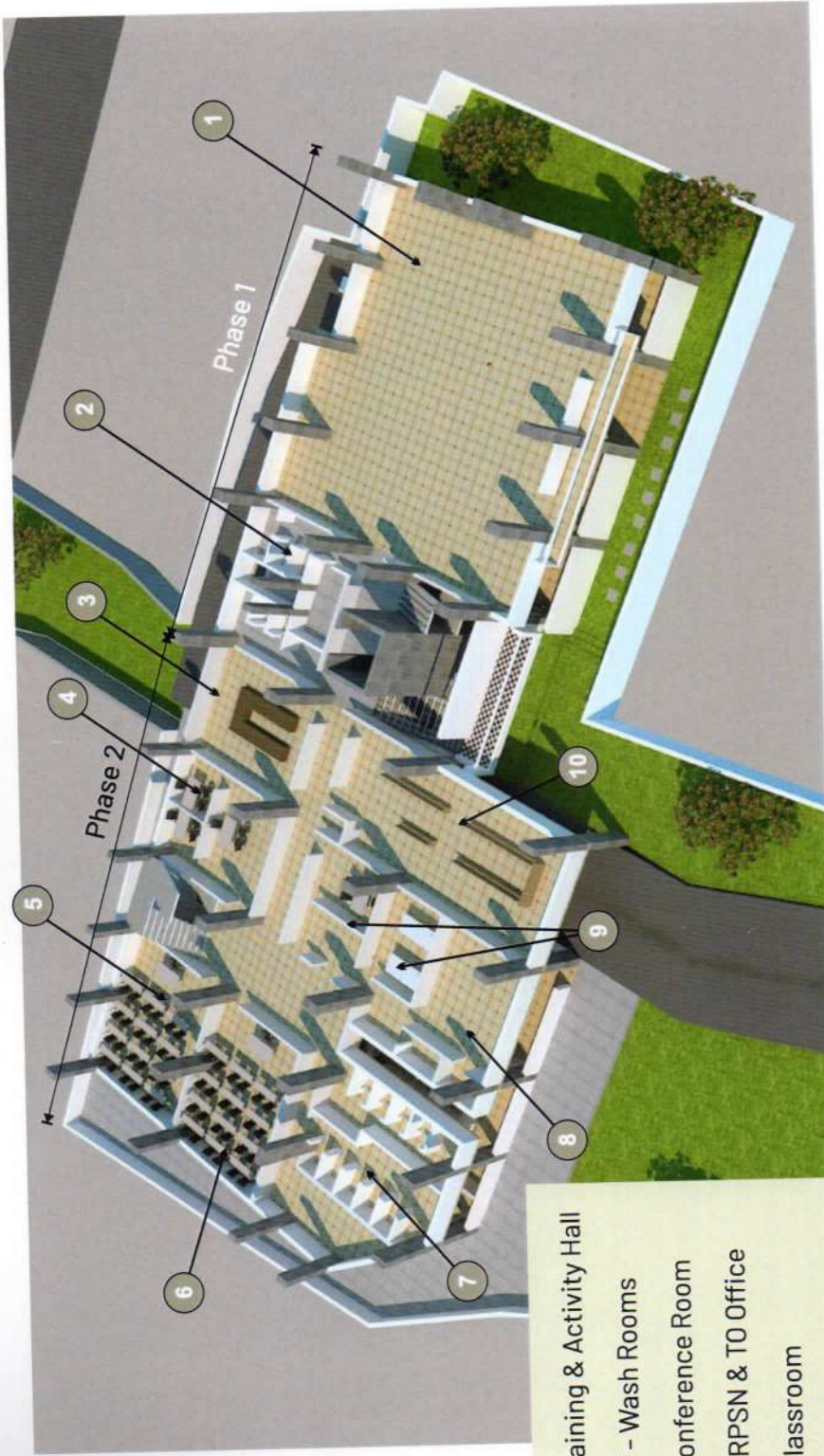

- 1 - Training & Activity Hall
- 2 & 7 - Wash Rooms
- 3 - Conference Room
- 4 - TRPSN & TO Office
- 5 - Classroom
- 6 - Classroom
- 8 - Yoga Centre
- 9 - Medical Facility Room
- 10 - Exhibition Hall

Phase 1 : 307 sq.m. (3303.32 sq.ft.)

Estimated Amount : Rs. 55 Lakh

Phase 2 : 487 sq.m. (5240.12 sq.ft.)

Estimated Amount : Rs. 82 Lakh

Total Built-up Area : 794 sq.m. (8543.44 sq.ft.)

Second Floor Plan

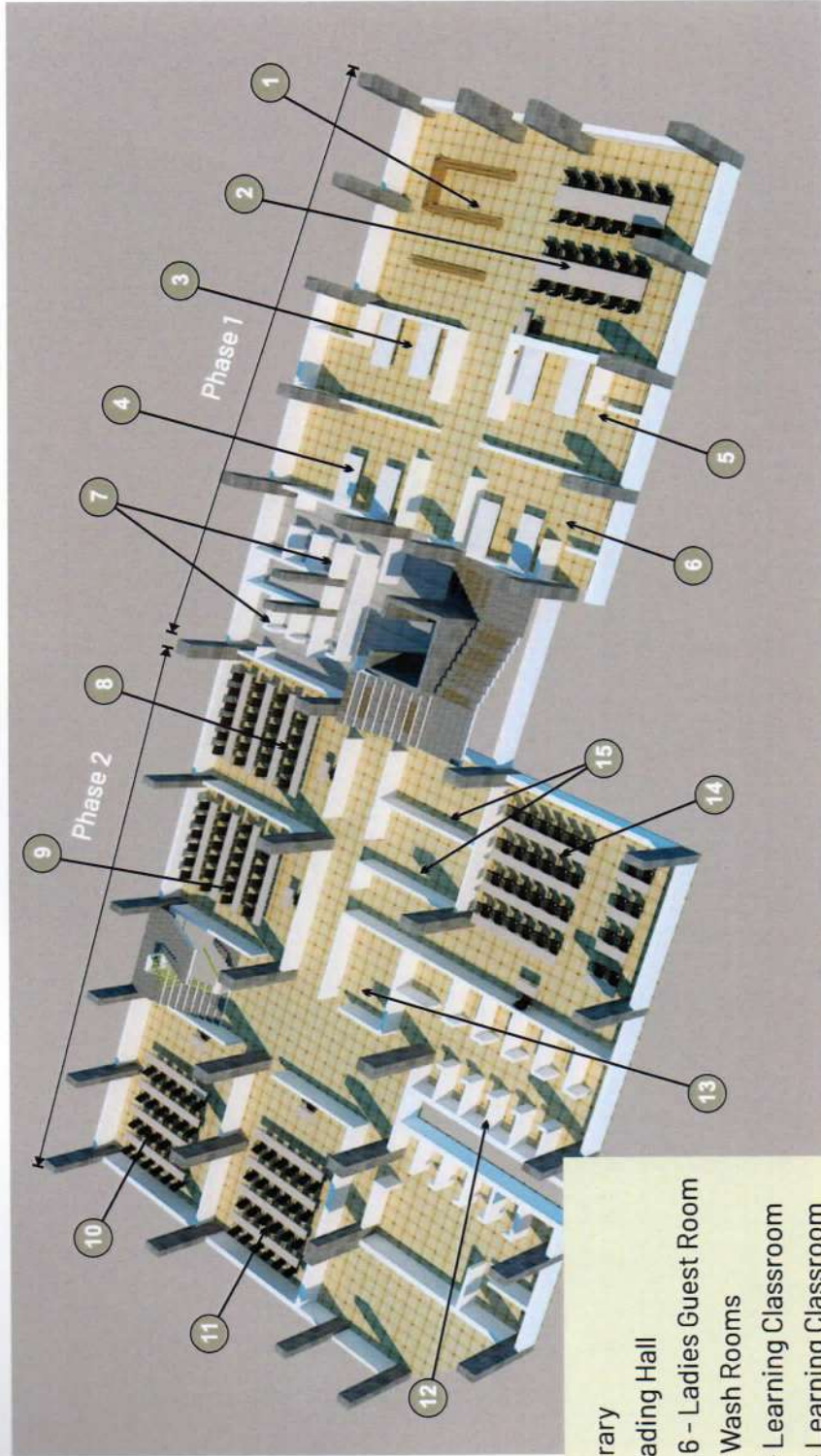

- 1 - Library
- 2 - Reading Hall
- 3, 4, 5, 6 - Ladies Guest Room
- 7, 12 - Wash Rooms
- 8 - E - Learning Classroom
- 9 - E - Learning Classroom
- 10 - Classroom
- 11 - Classroom
- 13 - Rector's Room
- 14 - Faculty Rest Room (G)
- 15 - Faculty Rest Room (L)

Phase 2 : 487 sq.m. (5240.12 sq.ft.)
 Estimated Amount : Rs. 82 Lakh

Phase 1 : 307 sq.m. (3303.32 sq.ft.)
 Estimated Amount : Rs. 55 Lakh

Total Built-up Area : 794 sq.m. (8543.44 sq.ft.)

Third Floor Plan

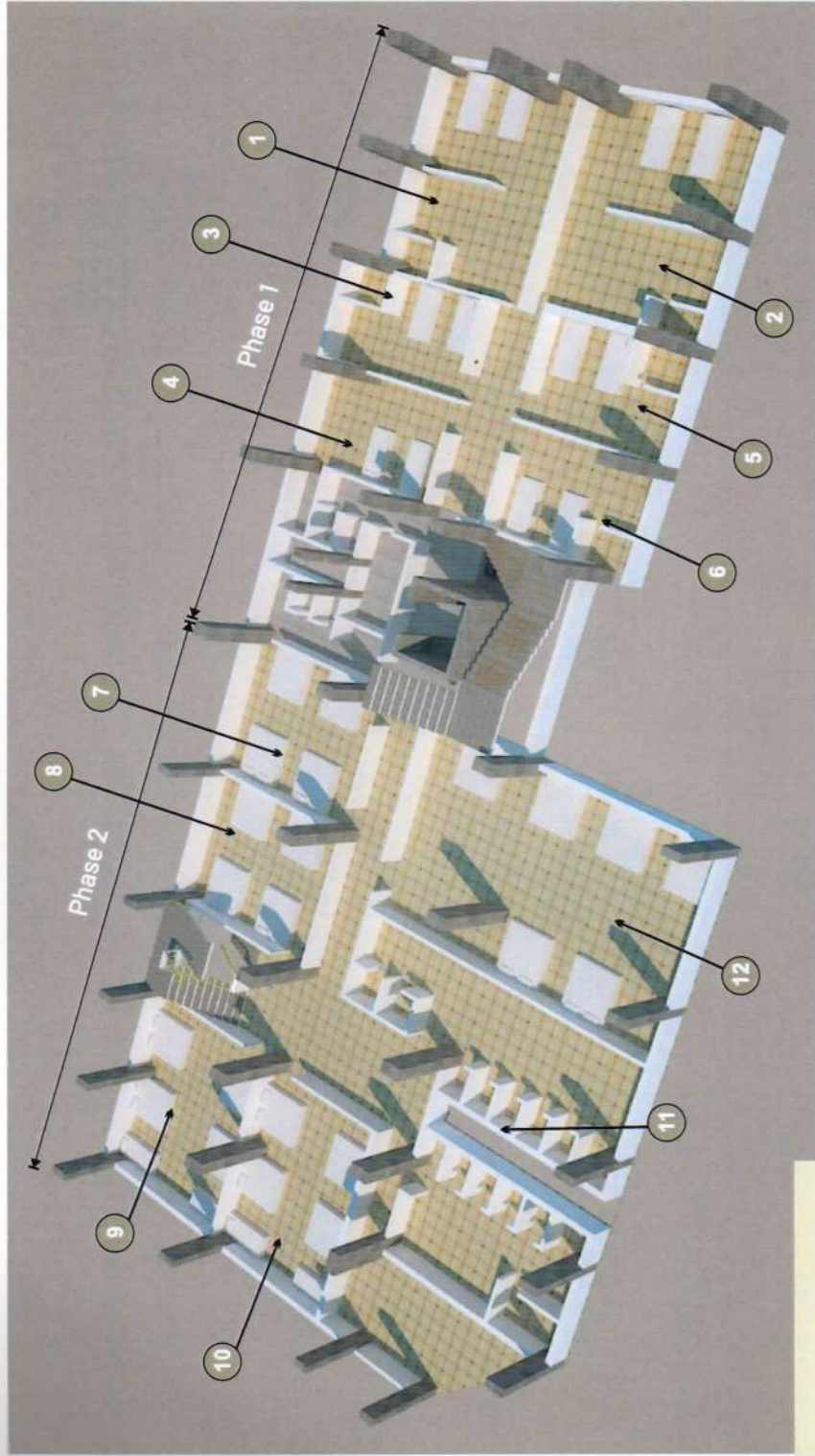

- 1 & 2 - Caretaker's Residence
- 3, 4, 5, 6 - Gents Guest Room
- 7, 8, 9, 10, 12 - Boys Students' Hostel Rooms
- 11 - Washrooms

Phase 2 : 487 sq.m. (5240.12 sq.ft.)
 Estimated Amount : Rs. 82 Lakh

Phase 1 : 307 sq.m. (3303.32 sq.ft.)
 Estimated Amount : Rs. 55 Lakh

Total Built-up Area : 794 sq.m. (8543.44 sq.ft.)

CSR Associations

TORANA RAJGAD PARISAR SAMAJONNATI NYAS

has achieved to be associated with following eminent CSR partners

 PERSISTENT FOUNDATION	 BAJAJ FINSERV	 Cognizant	 KALYANI TECHNOFORGE
NTT DATA	 Miba	 MITCON CONSULTANCY & ENGINEERING SERVICES LTD.	 ARAI Progress through Research
KPIT			

Appeal

To make Velhe and Bhor residents more and more capable to overcome the challenges and to stand in their lives on their own,

Torana Rajgad Parisar Samjonnati Nyas

has ideated the project of

Multi Activity Centre

facilitating Skill Development, Rural Development, Boys hostel,
Women empowerment, Agriculture promotion,
E-Seva Centre and more.

We, Torana Rajgad Parisar Samajonnati Nyas appeal to the society, to contribute more and more in this project financially, physically, mentally and be a part of this noble nation building mission.

Let's contribute.... Let's strengthen our India !

| हम करें राष्ट्र आराधन |